

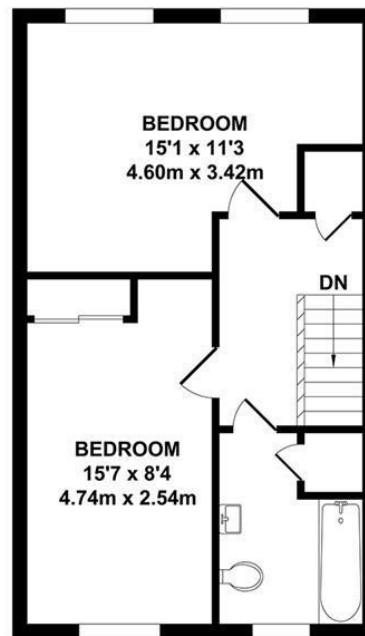

GROUND FLOOR
APPROX. FLOOR AREA
410 SQ.FT.
(38.08 SQ.M.)



FIRST FLOOR
APPROX. FLOOR AREA
410 SQ.FT.
(38.08 SQ.M.)

TOTAL APPROX. FLOOR AREA 820 SQ.FT. (76.16 SQ.M.)

Whilst every attempt has been made to ensure the accuracy of the floor plan contained here, measurements of doors, windows, rooms and any other items are approximate and no responsibility is taken for any error, omission or mis-statement. This plan is for illustrative purposes only and should be used as such by any prospective purchaser. The services, systems and appliances shown have not been tested and no guarantee as to their operability or efficiency can be given.
Zome Media ©2024



01732 522 822
info@khp.me



Phoenix Road
Tonbridge TN12 9FR
Fixed Asking Price £133,000

Tenure: Leasehold

Council tax band: C



****35% SHARED OWNERSHIP - VIEWING AVAILABLE NOW****

This two bed semi detached home is situated in Marden, a rural Kentish village that has everything you could possibly need. With great amenities, doctors, dentist, pharmacy and petrol station. You also have a few takeaways, locals shops, pub, bakers and butchers. What makes this village so perfect is not only do you have all of the above but you also have a main line station that takes less than an hour to get to London.

This lovely home comprises of a downstairs toilet, Modern kitchen, living room /dining room. On the first floor there are 2 bedrooms, a bathroom and spacious landing with storage space.

Externally the property has a low maintenance garden and an two allocated parking spaces to the front.

Call now to arrange your viewing. (FULL PRICE £380,000)

- SOLD BY KHP
- 35% SHARED OWNERSHIP
- Semi Detached
- 2 Parking spaces
- Modern Kitchen
- Downstairs W/C
- Close to amenties
- Trains to London within the hour

Energy Efficiency Rating		Environmental Impact (CO ₂) Rating	
Current	Potential	Current	Potential
England & Wales		England & Wales	



ADDITIONAL INFORMATION

Leasehold -119 years left
Council Tax Band - C
Service charge - £36 PCM
Rent - £673.78
EPC Rating - B
35% Share
MHS housing association

DISCLAIMER

All dimensions are approximate and any floor plans are for guidance purposes only. Reference to appliances and/or services does not imply that they are necessarily in working order. Whilst we endeavor to make our sales particulars as accurate as possible, all interested parties must verify their accuracy themselves.

